

Sensory and Access Map

Main building

Introduction

Welcome to The Art Gallery of Western Australia. This Sensory and Access Map is designed to help you identify sensory friendly spaces, and to assist with navigating your way around the Gallery.

Please use this as a guide for finding quieter and less crowded spaces, seating areas within the Gallery, and spaces with tactile engagement and activities.

For more accessibility information visit our website or speak with a member of staff at our Information Desk.

Sections

- 2 Introduction
- 3 Seating areas and less crowded, quieter spaces
- 5 Gallery 09 engagement space
- 6 Access

Seating areas and less crowded, quieter spaces

The quietest and least crowded times to visit the Gallery are usually 3–5pm. School holidays are often the busiest times to visit.

Seating is usually offered in every exhibition space as well as the locations shown on the map on the next page.

Our exhibition spaces are most often easy to navigate, not overly loud or containing sensory stimulation materials. However, it does vary by exhibition and to help plan your visit exhibition-specific Sensory and Access Maps are available for exhibitions that require them.

Seating areas and less crowded, quieter spaces

 Seating  Less crowded, quieter spaces

ROOFTOP

The Rooftop is usually our quietest and least crowded level, with much of this level being a large outdoor space.

It can become crowded and noisy during Bar opening hours (warmer months, Fri–Sun, 3pm–late).

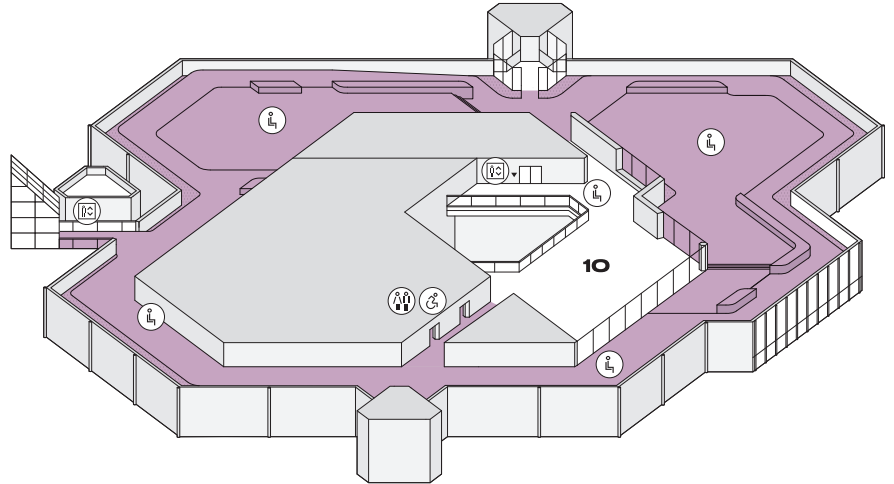

LEVEL ONE

Level One isn't too loud or crowded, being mostly exhibition spaces.

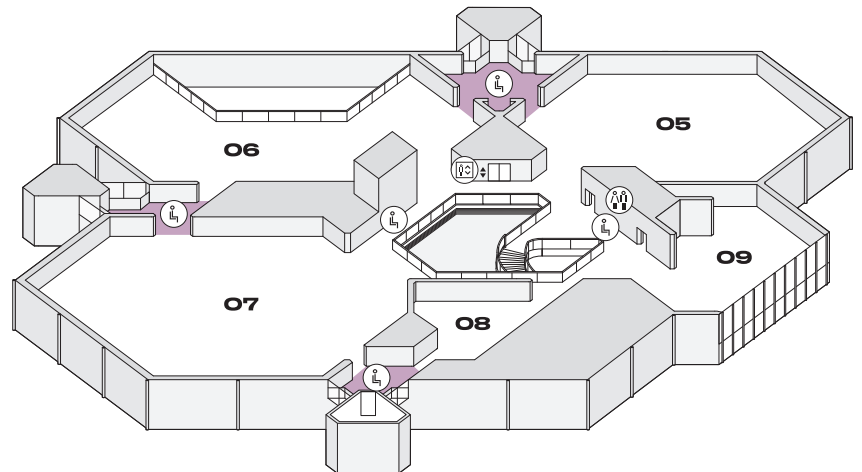

GROUND FLOOR

The Ground Floor is often our loudest and most crowded level, especially in the Foyer area near the Main Entrance, and in the Design Store and Cafe & Bar. Exhibition spaces can be less crowded and rest areas provide quiet spaces for a break.

There is a large, bright LED screen with video and changing images to the left of the Information Desk.

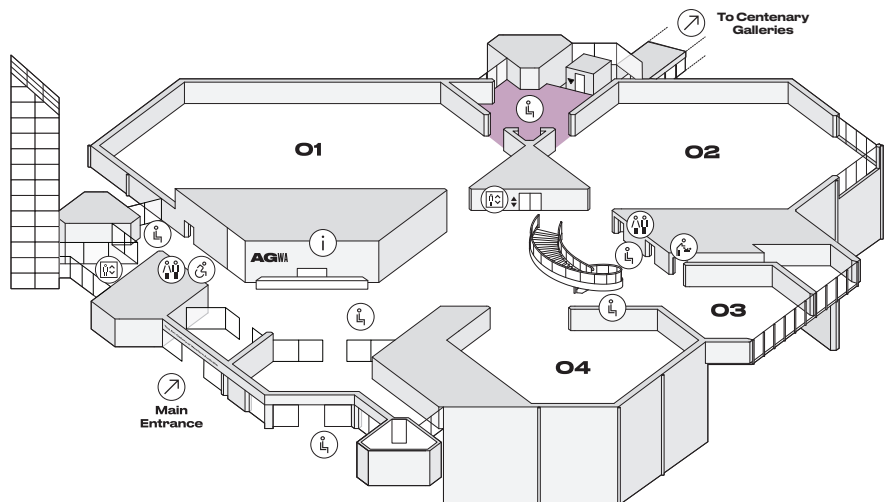

KEY

 Information Desk  Lifts  Toilets  Parents / Carers Room

Gallery 09 engagement space

LEVEL ONE

Gallery 09 is an all-ages multi-sensory space that is designed to adapt to all abilities through engagement and conversation. You can speak with one of the staff if you or someone you're with has any specific needs so you can meaningfully engage and feel safe here.

There are dedicated staff and volunteers in this space.

Parents/carers must remain with children.

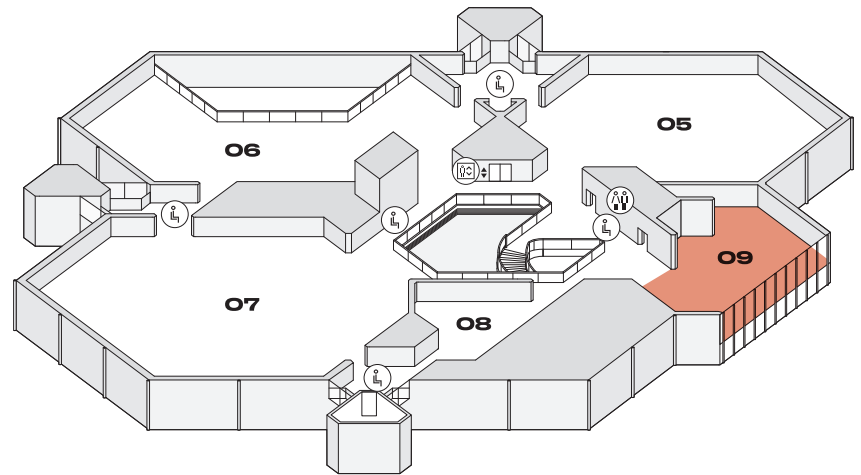

Access



ROOFTOP

The Rooftop level can be accessed via the two Gallery lifts only. The main (internal) lift services all levels of the Gallery, while the external lift services Ground Level and Rooftop only.

On the Rooftop level the external lift opens directly to the outside.

There are a number of small stair sets and gentle ramps and on this level.

A UAT (Universal Accessible Toilet) and ambulant toilets are available on this level.

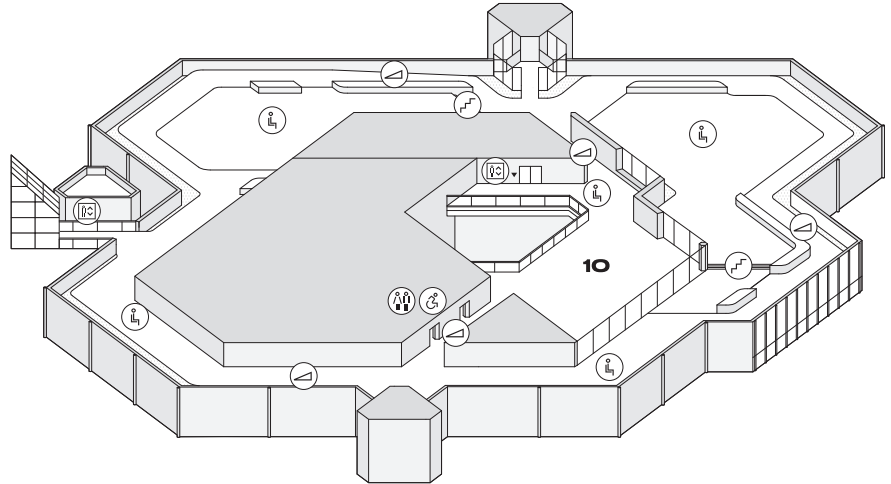

LEVEL ONE

The ground is level throughout this floor.

There is no UAT or ambulant toilet available on this level.

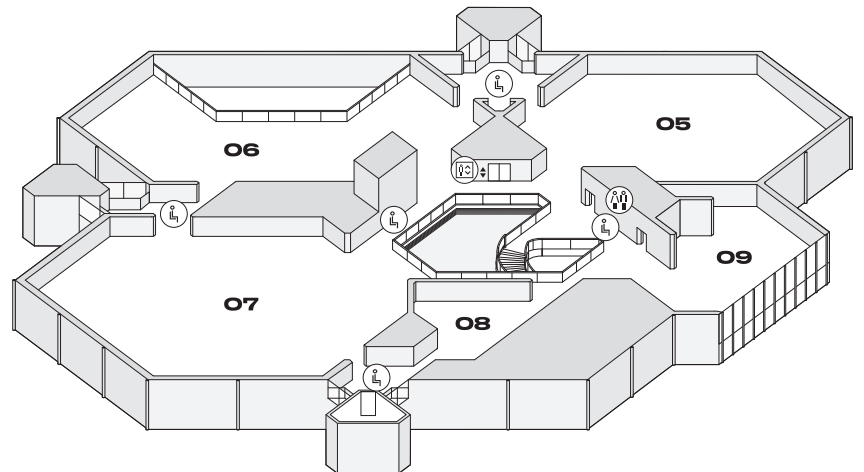

GROUND FLOOR

The ground is level throughout this floor.

A walking frame, manual wheelchairs and an electric buggy are available for visitor's use. These are located at the Information Desk. Bookings are advisable to ensure availability. Please provide 24-hour notice for the electric buggy as it will need to be charged. For bookings telephone +618 9492 6601.

A UAT and ambulant toilets are available on this level.

There is a parents/carers room available on this level with a sink, baby change table and privacy cubical (cubical with a curtain).

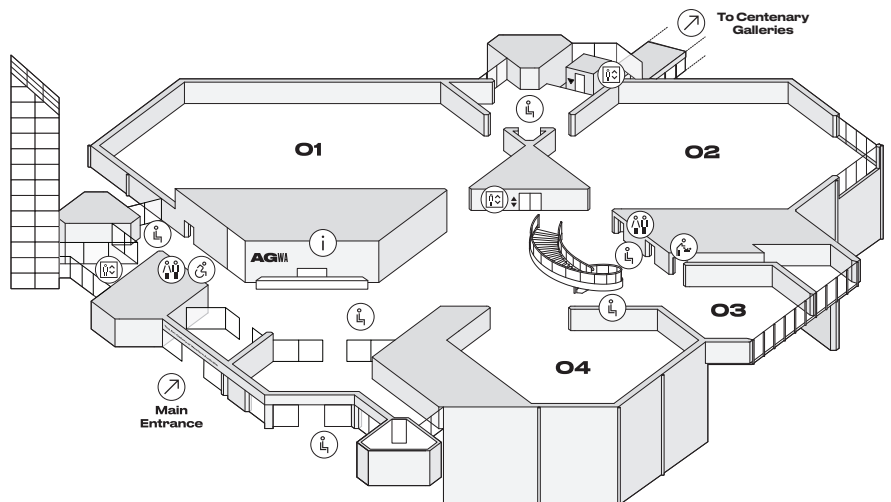

KEY

