

The West Australian Pulse 2025

Sensory and Access Map

Introduction

Welcome to The Art Gallery of Western Australia. This Sensory and Access Map is designed to show where sensory elements, audio-visual content and seating is within this exhibition.

Visit artgallery.wa.gov.au/plan-your-visit for information on planning your visit and for more accessibility resources.

Sensory and Access Map: *The West Australian Pulse 2025*

LOWER CENTENARY GALLERIES

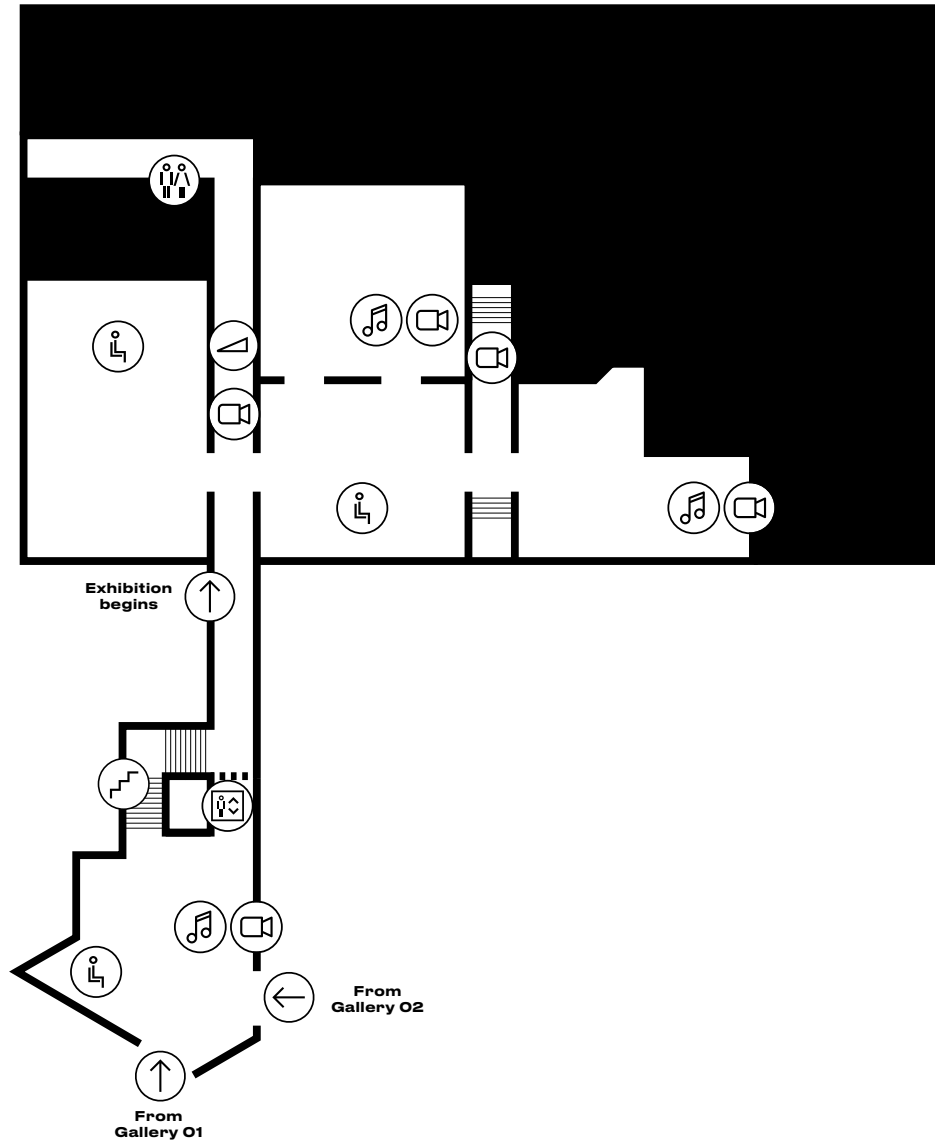

In the main Gallery building a universal access toilet (RH) is located on Ground Floor, and a universal access toilet (LH) on Rooftop level. Ambulant toilets are located on Rooftop level, and a Parent's / Carer's room on Ground Floor.



Noise-cancelling headphones are available at the Information Desk on request.

KEY

