

AGWA

Cover: Harrison Zupp *Tuned to life* 2025. Oil on board, 86 x 62 cm. Emmanuel Catholic College. Photo: Christophe Canato.

III JUNPER JETE Beverage Partners

healthway SEW-ARTS Art Access Partner

The West Australian Pulse Partners
The Artist Australian JDecaux nova 93.7 Department of Education

Naming Rights Partner Outdoor Media Partner Broadcast Partner

The Art Gallery of Western Australia Major Partners
Westfarmers Arts AGWA Financial Partner SIMON LEE FOUNDATION TO CELEBRATE THE BIRTHDAY OF THE WESTERN AUSTRALIAN PULSE PARTNERS The Artist Australian JDecaux nova 93.7

artgallerywa.gov.au
@artgallerywa #artgallerywa
artgallerywa.gov.au

Kedela wer kalyakoorl ngalak Wadjak boodjak yaak.
Today and always, we stand on the traditional land
of the Whadjuk Noongar people.

Gallery Map

The West Australian

PULSE



EXHIBITION

*The future
is ours to create*

Free Exhibition
16 May – 13 Sep 2026

The Art Gallery of Western Australia

ROOFTOP

AGWA Rooftop

Rooftop:
10am-5pm daily except Tue
AGWA Rooftop is a 500-person venue offering unparalleled 360° views of the Perth CBD skyline.

Christopher Pease Targets

This 34-metre long, five-metre tall printed metal and light-based artwork wraps around the Rooftop's exterior walls, reflecting on place, belonging, and the centrality of the Derbarl Yerrigan (Swan River) to both.

Sculpture Walk

AGWA Rooftop hosts an open-air sculpture park featuring works from the State Art Collection, including Gerhard Marcks' *The Caller* and Henry Moore's *Reclining Figure*, among others.

Sculptures

- S1 Barbara Hepworth
- S2 Jean Arp
- S3 Henry Moore
- S4 Gerhard Marcks
- S5 Henri Laurens
- S6 Oliffe Richmond
- S7 Émile Bourdelle

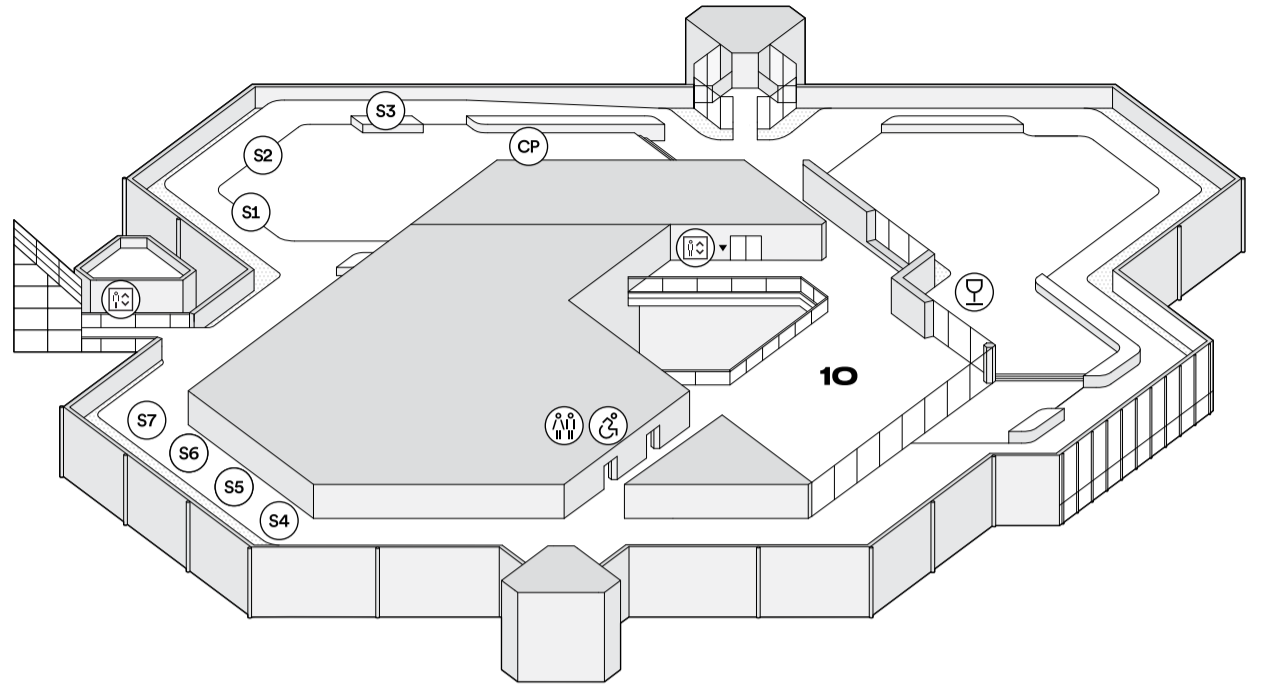

LEVEL ONE

The West Australian Pulse 2026 Gallery 05 | Until 13 Sep

WA's talented young artists are celebrated in this yearly showcase, gauging the pulse of young people who will influence, empower and shape the world we live in. *The West Australian Pulse 2026* celebrates 34 years and features 63 works by 2025 Year 12 Visual Arts graduates from 43 schools across WA.

Attachment Styles: Modes of Belonging in Modern and Contemporary Art Gallery 06 | NOW ON

Why do we crave closeness while keeping one foot out the door? Why do we love, withdraw, cling to or sabotage our connections with others? *Attachment Styles* brings together works from the 19th to 21st century to explore these questions, showing how artists have long grappled with the emotional complexity of human relationships between individuals, communities and the environments they inhabit.

Theo Koning: Object Syntax Gallery 08 | Until 19 Jul

Presenting a focused display of works from the State Art Collection by Theo Koning (1950-2022), one of Western Australia's leading-edge figures working in installation and process-oriented art.

Bruce Asbestos: Cranky Pants Gallery 09 | NOW ON

Cranky Pants, in collaboration with UK artist Bruce Asbestos, is an interactive exhibition celebrating rebellious emotion and disobedient design. Set within a vivid pop art world of larger than life characters, families and participants of all ages are invited to design hyper-couture costumes and accessories for the catwalk.

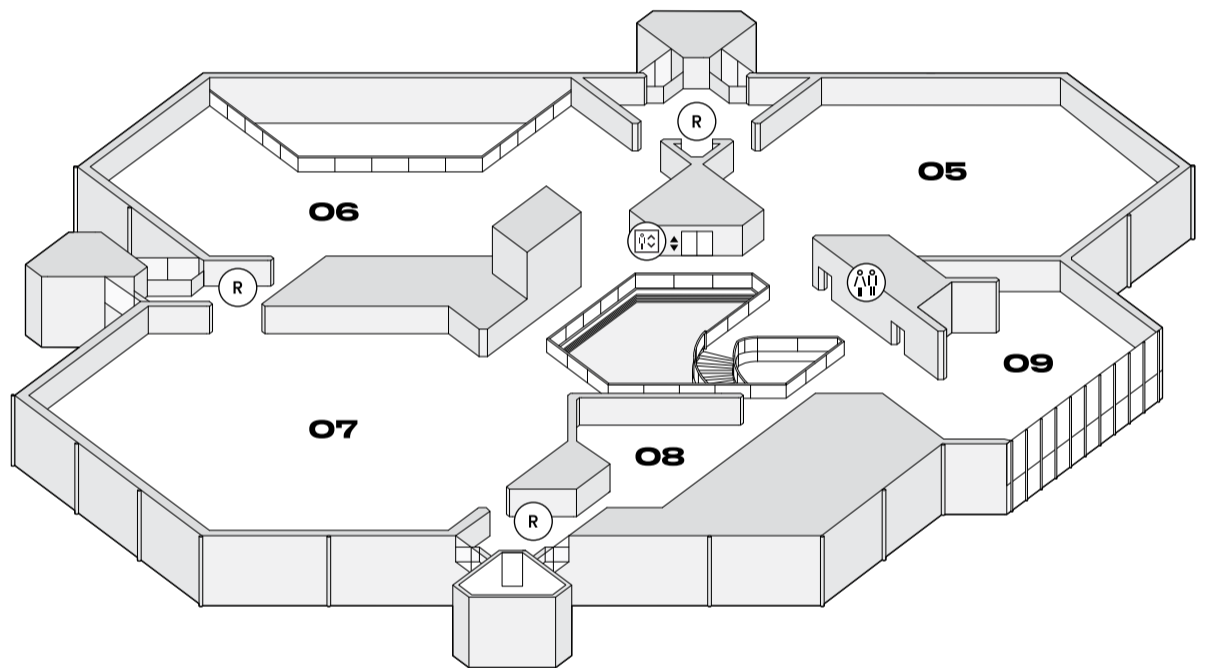

GROUND FLOOR

Trần Lương: Tắm Tã – Soaked in the Long Rain Gallery 01 | Until 16 Aug

Spanning painting, performance and socially engaged practice, *Tắm Tã – Soaked in the Long Rain* explores the life of an artist who, over the last thirty years, has shaped the development of critical contemporary art in Vietnam. This exhibition is curated by Biljana Ciric and co-organised by The Art Gallery of Western Australia, Art Jameel and Govett-Brewster Art Gallery | Len Lye Centre.

I AM Gallery 02 | NOW ON

Drawn from the State Art Collection, *I AM* celebrates the diversity of Aboriginal art and culture. The exhibition centres on personal and shared stories that elevate Aboriginal knowledge and perspectives on the world and our place in it. Themes span ancestral creation stories, artists' connections to Country, and lived experience. *I AM* reflects the dynamism of Aboriginal art—from deeply rooted traditions to bold contemporary expression.

Stormie Mills: All the secrets are buried between the oceans and the mountains COMING SOON

From street walls to the state gallery, Stormie Mills has spent forty years painting a path of connection. This first Australian state gallery exhibition presents a new body of work reflecting a career that began with a mark on a wall in the darkness of night and now reaches public spaces and galleries worldwide. Shaped by formative encounters and global travel, Mills moves between places where stories are hidden and shared. These stories move among our layered selves and surroundings, and into galleries where ideas are gathered and brought into view. Titled *All the secrets are buried between the oceans and the mountains*, the exhibition explores the people and places Mills has encountered – individuals with their own secrets, forming communities connected through a shared creative language.

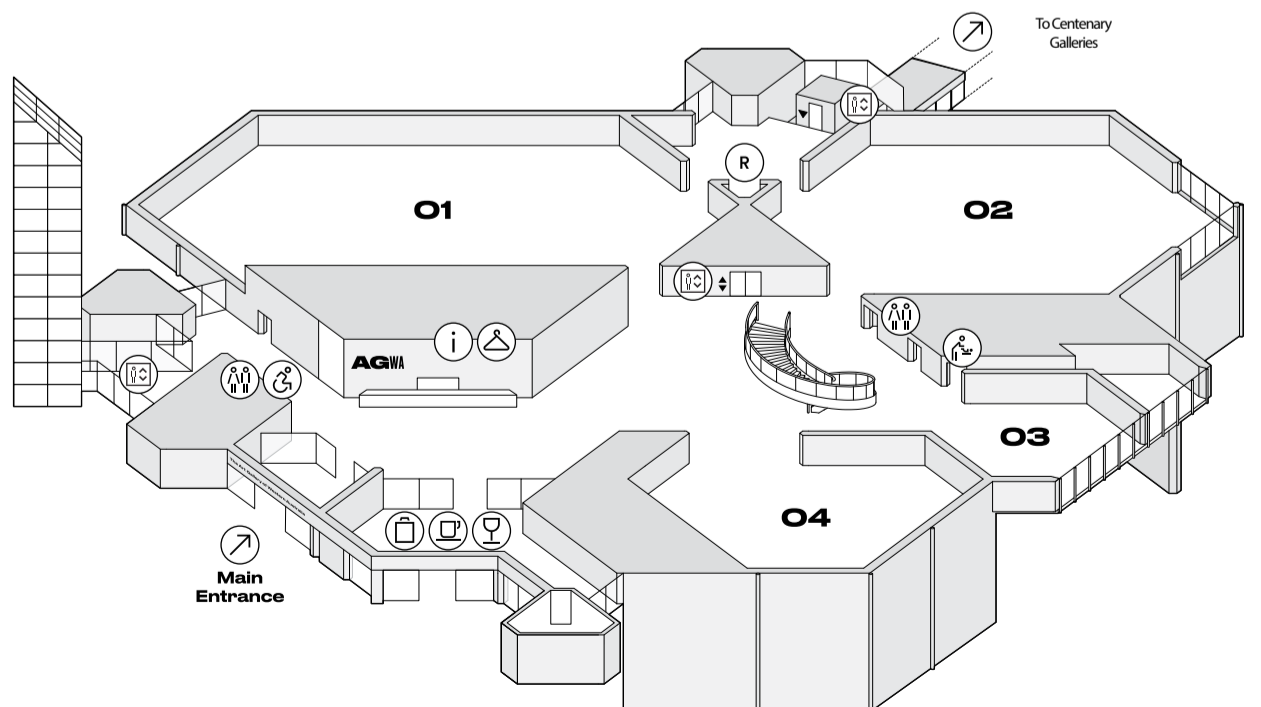

Please note, exhibitions may contain works with mature content. Please ask at the Information Desk for further information.

KEY

- Information Desk
- Cloak Room
- AGWA Design Store
- Cafe
- Bar
- Lifts
- Toilets
- Parents / Carers Room
- Rest Area